

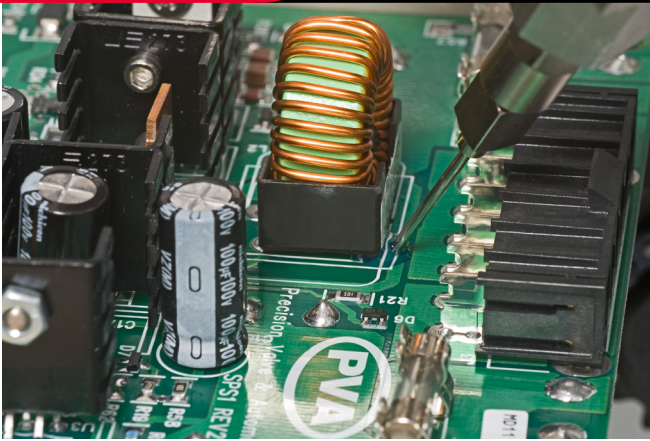

INNOVATION. **PRECISION.** EXCELLENCE.



## System Specifications

### Dispense Valve

FC100

### Dispense Outlet

Luer lock adapter

### Pressure Tank

PVA-5LTUV

### Controller

ST100 with PV101E

### Fluid Viscosity Range

1 cps - 20,000 cps (self-leveling fluid)

### Wetted Components

Stainless Steel, Teflon, Kalrez

### Air

80 psi  
(5.5 bar)

### Power Requirements

115V/230V, 50-60 Hz

### Optional Equipment

PV106-S valve stand with solvent/purge cup  
PV101 pneumatic trigger handle



## FC100-5LT-1-H

### Benchtop Dispense System

This complete manual dispense system is typically used for handheld dispensing and potting applications. It utilizes the FC100 dispense valve mounted to an electric trigger to activate the ST100 valve controller. The valve controller can be set in Manual mode to apply fluid for the duration the trigger is depressed or Timed mode for single pulse repeatable volumes.

Supplied with a 5-liter pressure tank, it can hold most industry standard 5-liter or 1-gallon bottles/cans, eliminating the need to pour fluid into a tank which can introduce moisture and air.

Complete systems are supplied with all necessary fluid and air fittings and tubing (6 ft) to operate out of the box.

The FC100-5LT-1-H has many additional integrated features including:

- Ability to dispense manual or timed volumes
- Hand trigger activation
- Handheld adhesive or potting dispense system

**For more information, please contact PVA at [info@pva.net](mailto:info@pva.net) or contact your local representative.**

REV - 3/2024

**Headquarters**  
6 Corporate Drive | Halfmoon, NY 12065  
tel +1 518 371 2684 | fx +1 518 371 2688  
[www.pva.net](http://www.pva.net) | [info@pva.net](mailto:info@pva.net)

# System Assembly

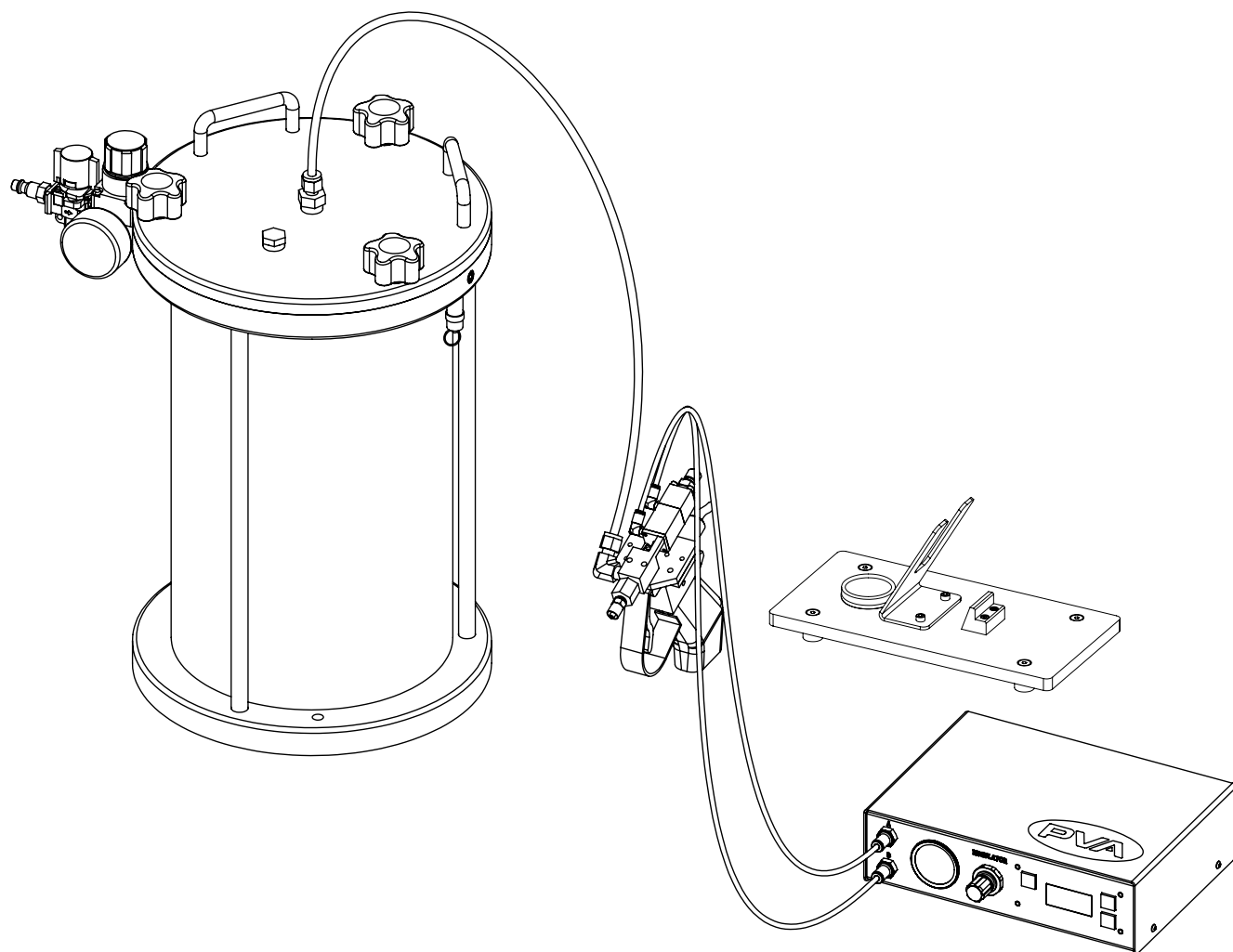

*System shown above includes optional PV106-S Valve Stand with solvent/purge cup.*