

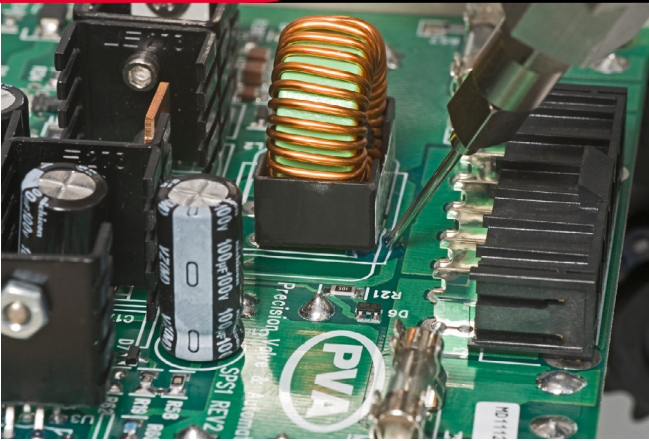

INNOVATION. **PRECISION.** EXCELLENCE.



System Specifications

Dispense Valves

FCS300-R
CAM200

Spray Pattern Diameter (FCS300-R)

6.35 mm - 50.8 mm
(0.25 in - 2 in)

Dispense Outlet (CAM200)

Luer lock adapter

Pressure Tank

PVA-2G

Fluid Viscosity Range

1 cps - 20,000 cps (self-leveling fluid)

Wetted Components

Stainless Steel, Teflon, Kalrez

Air

80 psi
(5.5 bar)

Optional Equipment

PV106-S valve stand with purge cup for FCS300-R
PV105-01 valve stand with purge cup for CAM200
FX800 fume extraction system



MCCS-SYS-5

Manual Conformal Coating System

This complete manual conformal system combines one FCS300-R atomized spray valve to apply fluid over a large area and one CAM200 lever activated diaphragm dispense valve for detailed application of beads close to keep out areas. Both applicator technologies are typically used in a selective conformal coating station to achieve the best results. The spray valve is mounted to a pneumatic trigger handle for independent activation of the spray or lever activated dispense valve, making it easy for the operator to switch between application methods.

Supplied with a 2-gallon stainless steel pressure tank, compatible fluids can be poured into the tank through the oval opening in the lid, which will supply fluid to both valves.

Complete systems are supplied with all necessary fluid and air fittings and tubing (6 ft) to operate out of the box.

The MCCS-SYS-5 has many additional integrated features including:

- Low volume, low pressure atomized spray valve for manual conformal coating of PCBs
- Dispense valve with outlet for luer lock needles

For more information, please contact PVA at info@pva.net or contact your local representative.

REV - 3/2024

Headquarters
6 Corporate Drive | Halfmoon, NY 12065
tel +1 518 371 2684 | fx +1 518 371 2688
www.pva.net | info@pva.net

System Assembly

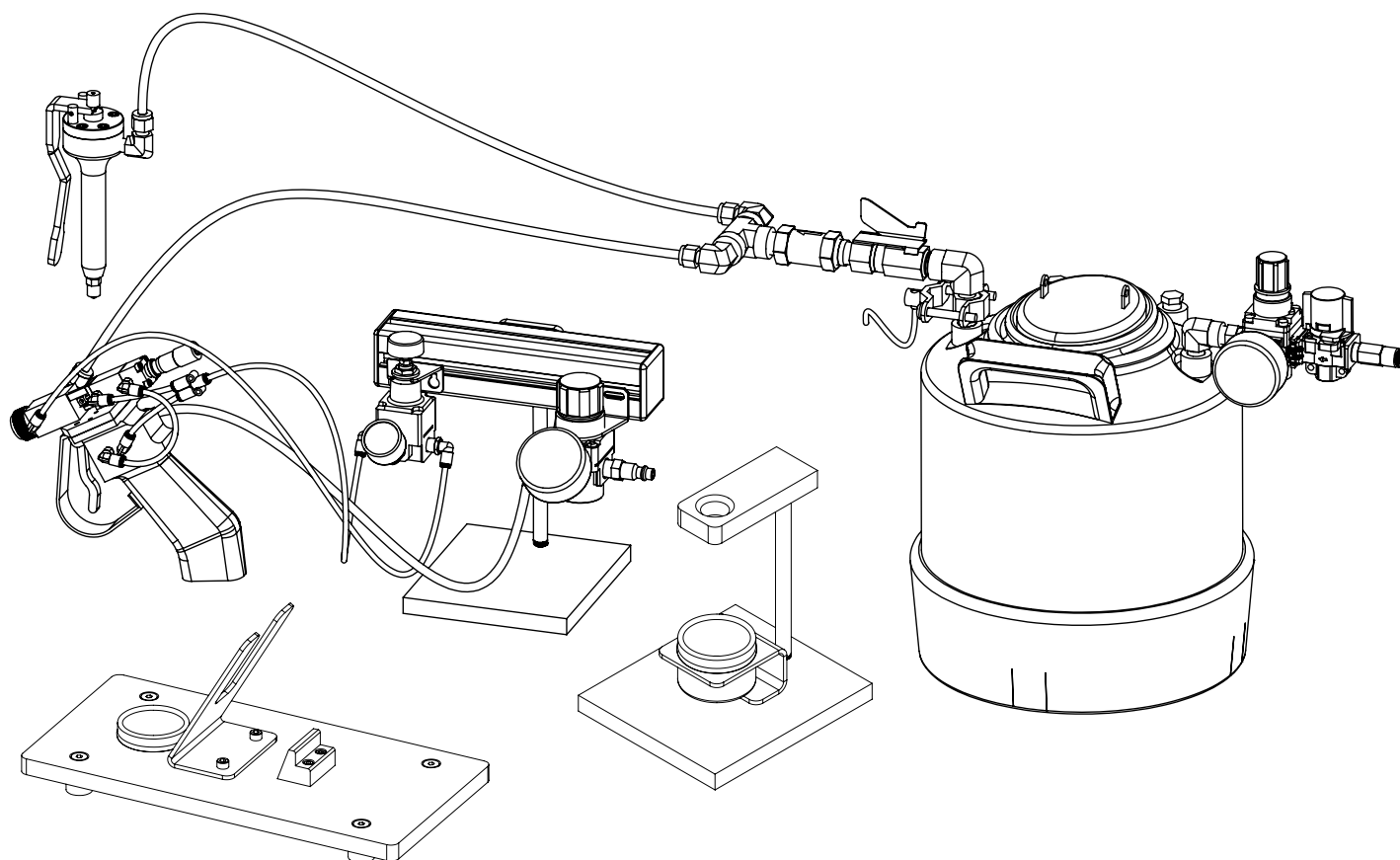

System shown above includes optional PV106-S and PV105-01 Valve Stands with solvent/purge cups.